

TQM/31, QM/32

Magnetically operated switches with reed contact

Alternative materials allows a wide range of application

Switch with plug



Technical features

Operation:
TQM/31, QM/32 normally open with LED (yellow)

Switching voltage (U_b):
10 ... 240 V a.c./d.c.

Switching voltage output:
U_b - 2 V (QM/32)

Switching current (see graph overleaf):
1 A max. (QM/32)

Switching power:
50 W/50 VA max.

Contact resistance:
100 mΩ

Response time:
3 ms

Operating temperature:
-20 ... +80°C,
High temperature version: +150°C max. (QM/31)

Protection rating (EN 60529):
IP 66

Shock resistance:
50 g (during 11 ms)

Vibration resistance:
35 g (50 to 2000 Hz)

Cable type:
PVC 2 x 0,75, PUR 2 x 0,75
Silicon 2 x 0,75 (QM/31)

Cable length:
2, 5 or 10 m

Electromagnetic compatibility according to:
EN 60947-5-2

Materials:
Body: plastic
Cable: see table below

Technical data, standard models

Symbol	Voltage (V a.c.)	Voltage (V d.c.)	Current max. (A)	Function	Temperature (°C)	LED	Protection class	Features	Cable length (m)	Cable type	Weight (g)	Model
BN	10 ... 240	10 ... 240	1	Closer	-20 ... +80	•	IP66	—	2, 5 or 10	PVC 2 x 0,75	108 (2 m)	QM/32/*
BU	10 ... 240	10 ... 240	1	Closer	-20 ... +80	•	IP66	—	2	PUR 2 x 0,75	108	QM/32/2/PU
BN BU	10 ... 240	10 ... 240	2	Closer	-20 ... +150	—	IP66	High temperature	2, 5 or 10	Silicon 2 x 0,75	102 (2 m)	TQM/31/*
BN BK	10 ... 240	10 ... 240	1	Closer	-20 ... +80	•	IP66	Plug M12 x 1	—	—	15	QM/32/P *1)

* Insert cable length

*1) Plug-in connector see page 2

Color code: BK = black, BN = brown, BU = blue

Options selector

Options selector	Substitute	Options selector	Substitute
High temperature (+150°C), for TQM/31/* only	T	Cable	Without
Reed with LED	2	PUR	PU
Reed without LED, for TQM/31/* only	1	Cable length/plug	2 m
			5 m
			10 m
		With plug	M12 x 1
			P

★QM/3★/★/★

Switching current and switching voltage
TQM/31

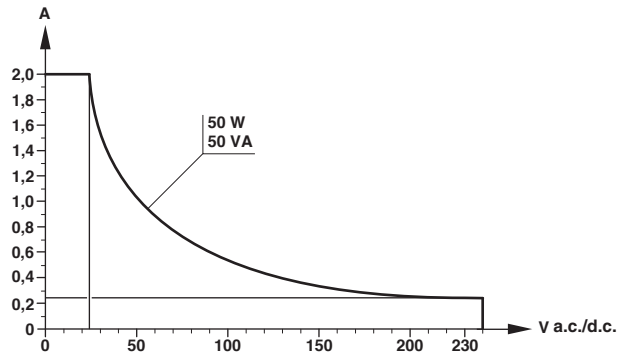

QM/32

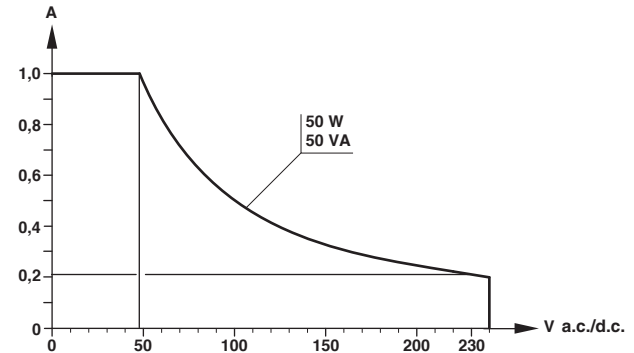

Mounting elements for magnetic switches

Cylinder with external tie rods RA/8000/M, RA/28000/M		Cylinder with external tie rods RM/900/M	
Mounting elements		Mounting elements	
Cylinder Ø (mm)	Model	Cylinder Ø (inch)	Model
32 ... 63	QM/31/032/22	1 1/4"	QM/31/032/22
80 ... 125	QM/31/080/22	1 3/4" + 2"	QM/31/080/22
160 + 200	QM/31/160/22	2 1/2" ... 4"	QM/31/2/22
250	QM/31/250/22		
320	QM/31/320/22		

Dimensions see relevant cylinder sheets.

Accessories

Plug-in connector cable with nut

Outer cover	Cable length	Weight (kg)	Connector	Model
PVC 3 x 0,34	5 m	0,182	M12 x 1	M/P34692/5
PUR 3 x 0,34	5 m	0,182	M12 x 1	M/P34594/5

Dimensions

TQM/31, QM/32

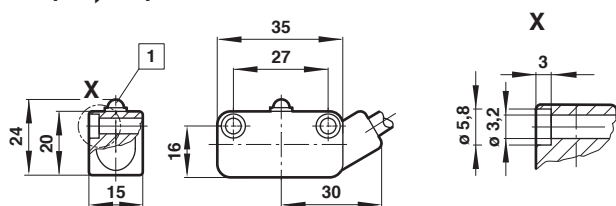

QM/32/P

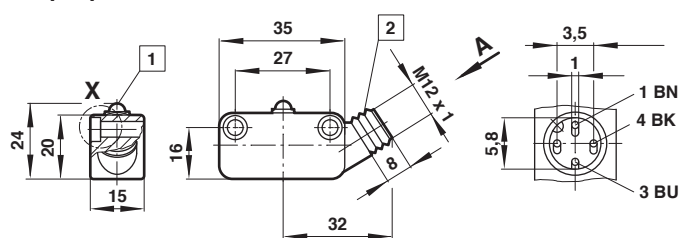

1 LED (yellow)
2 Plug M12 x 1
Color code: BK = black, BN = brown, BU = blue

Warning

These products are intended for use in industrial control systems only. Do not use these products where values can exceed those listed under **Technical features/data**.

Before using these products for non-industrial applications, life-support systems, or other applications not within published specifications, consult NORGREN.

Through misuse, age, or malfunction, components used in control systems can fail in various modes.

The system designer is warned to consider the failure modes of

all component parts used in control systems and to provide adequate safeguards to prevent personal injury or damage to equipment in the event of such failure.

System designers must provide a warning to end users in the system instructional manual if protection against a failure mode cannot be adequately provided.

System designers and end users are cautioned to review specific warnings found in instruction sheets packed and shipped with these products.